



MIXING CONSOLE

AG03 Technical Specifications

ZN43270

General Specifications

0 dBu = 0.775 Vrms, Output impedance of signal generator (Rs) = 150 Ω

All level controls are nominal if not specified.

| | | |
|---|--|---|
| Frequency Response | Input (MIC) to MONITOR OUT via USB IN/OUT | +0.5 dB/-1.5 dB (20 Hz to 48 kHz @ Fs = 192 kHz), refer to the nominal output level @ 1 kHz, GAIN knob: Min, TO PC: DRY CH1-2G |
| Total Harmonic Distortion *1 (THD+N) | Input to MONITOR OUT | 0.05% @ 0 dBu (20 Hz to 20 kHz), GAIN knob: Min 0.01% @ +4 dBu (1 kHz), GAIN knob: Min |
| Hum&Noise *2 (20 Hz to 20 kHz) | Equivalent Input Noise | -128 dBu (Mono Input Channel, Rs: 150 Ω, GAIN knob: Max) |
| | Residual Output Noise | -103 dBu (MONITOR OUT, MONITOR knob: Min) |
| Crosstalk (1 kHz) *3 | | -80 dB |
| Input Channels | | Mono (MIC/LINE): 1 including HEADSET MIC (Plug-in Power) (CH1 MIC and HEADSET MIC cannot be used simultaneously.), Stereo (LINE) / Mono (GUITAR) :1, USB IN:1, AUX IN:1 |
| Output Channels | | MONITOR OUT: 2, PHONES: 2 including HEADSET PHONES (PHONES and HEADSET PHONES cannot be used simultaneously.) |
| Bus | | Stereo: 1 |
| Input Channel Function (CH1) | PAD | 26 dB |
| | DSP | COMP/EQ, EFFECT (SPX Reverb) |
| | PEAK LED | LED turns on when the signal reaches 3 dB below clipping level. |
| Level Meter | USB Output Level | 2x2 point LED meter [PEAK, SIG] |
| USB Audio | 2 IN / 2 OUT | USB Audio Class 2.0 compliant, Sampling Frequency: Max 192 kHz, Bit Depth: 24-bit |
| Phantom Power Voltage | | +48 V |
| FOOT SW | | EFFECT Mute on/off |
| Power Requirements | | DC 5 V, 500 mA |
| Power Consumption | | Max. 2.5 W |
| Dimensions (WxHxD) | | 129 mm x 63 mm x 202 mm (5.1" x 2.5" x 8.0") |
| Net Weight | | 0.8 kg (1.8 lbs) |
| Included Accessory | | USB Cable (1.5 m), CUBASE AI DOWNLOAD INFORMATION, Owner's Manual, Technical Specifications (this leaflet) |
| Optional Accessory | | Foot Switch: FC5, Mic Stand Adaptor: BMS-10A |
| Operating Temperature | | 0 to +40°C |

*1 THD+N is measured with 22 kHz LPF.

*2 Noise is measured with A-weighting filter.

*3 Crosstalk is measured with 1 kHz band pass filter.

The contents of this manual apply to the latest specifications as of the printing date. Since Yamaha makes continuous improvements to the product, this manual may not apply to the specifications of your particular product. To obtain the latest manual, access the Yamaha website then download the manual file. Since specifications, equipment or separately sold accessories may not be the same in every locale, please check with your Yamaha dealer.

Analog Input Characteristics

0 dBu = 0.775 Vrms

| Input Jack | PAD 26 dB | GAIN Trim/SW Position | Actual Load Impedance | For Use with Nominal | Input Level | | | Connector |
|------------------------|-----------|-----------------------|-----------------------|----------------------|--------------------|--------------------|--------------------|--|
| | | | | | Sensitivity *1 | Nominal | Max. Before Clip | |
| MIC/LINE 1 HEADSET MIC | OFF | 10 | 3 kΩ 1.5 kΩ*4 | 50–600 Ω Mics/Lines | -72 dBu (0.195 mV) | -60 dBu (0.775 mV) | -50 dBu (2.451 mV) | Combo jack *2 (Balanced) 3.5 mm Phone jack for HEADSET MIC (Plug-in-Power/Unbalanced) |
| | | 0 | | | -26 dBu (38.84 mV) | -14 dBu (154.6 mV) | -4 dBu (489.0 mV) | |
| | ON | 10 | | | -46 dBu (3.884 mV) | -34 dBu (15.46 mV) | -24 dBu (48.90 mV) | |
| | | 0 | | | 0 dBu (775.0 mV) | +12 dBu (3.085 V) | +22 dBu (9.757 V) | |
| GUITAR 2G | - | HIGH | 1 MΩ | - | -32 dBu (19.5 mV) | -20 dBu (77.5 mV) | -10 dBu (245.1 mV) | Phone jack *3 (Unbalanced) |
| | | LOW | | | -12 dBu (194.7 mV) | 0 dBu (775.0 mV) | +10 dBu (2.451 V) | |
| LINE 2/3 | - | HIGH | 10 kΩ | 600 Ω Lines | -20 dBu (77.5 mV) | -8 dBu (308.5 mV) | +2 dBu (973.7 mV) | Phone jack *3 (Unbalanced) |
| | | LOW | | | -10 dBu (245.1 mV) | +2 dBu (975.7 mV) | +12 dBu (3.085 V) | |
| AUX | - | - | 10 kΩ | 600 Ω Lines | -14 dBu (154.6 mV) | -8 dBu (308.5 mV) | +2 dBu (975.7 mV) | Stereo mini jack |

*1 Sensitivity is the lowest level that will produce an output of +0 dBu (0.775 V) or the nominal output level when the unit is set to maximum gain. (All level controls are at their maximum position.)

*2 1&Sleeve = GND, 2&Tip = HOT, 3&Ring = COLD

*3 Tip = Signal, Sleeve = GND

*4 For CH1, HEADSET MIC

Analog Output Characteristics

0 dBu = 0.775 Vrms

| Output Terminal | Actual Source Impedance | For Use with Nominal | Output Level | | Connector |
|--------------------|-------------------------|----------------------|-----------------|-------------------|--|
| | | | Nominal | Max. Before Clip | |
| MONITOR OUT [L, R] | 150 Ω | 10 kΩ Lines | 0 dBu (0.775 V) | +10 dBu (2.451 V) | Phone jack *5 (Impedance Balanced) RCA pin (Unbalanced) |
| PHONES | 120 Ω | 40 Ω Phones | 1.5 mW + 1.5 mW | 6 mW + 6 mW | Stereo phone jack Stereo mini jack |

*5 Tip = HOT, Ring = COLD, Sleeve = GND

Digital Input / Output Characteristics

| Terminal | Format | Data Length | Sampling Frequency | Connector |
|----------|--|-------------|--|----------------|
| USB | USB Audio Class 2.0/ Yamaha Steinberg USB Driver | 24-bit | 44.1 kHz, 48 kHz, 88.2 kHz, 96 kHz, 176.4 kHz, 192 kHz | USB Standard-B |

Block and Level Diagrams

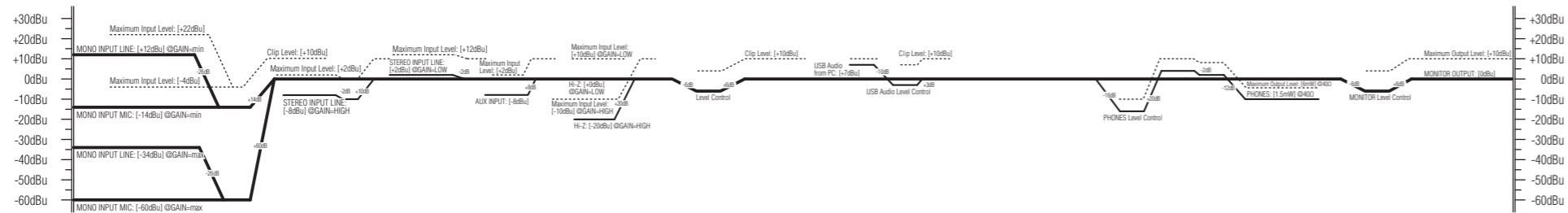
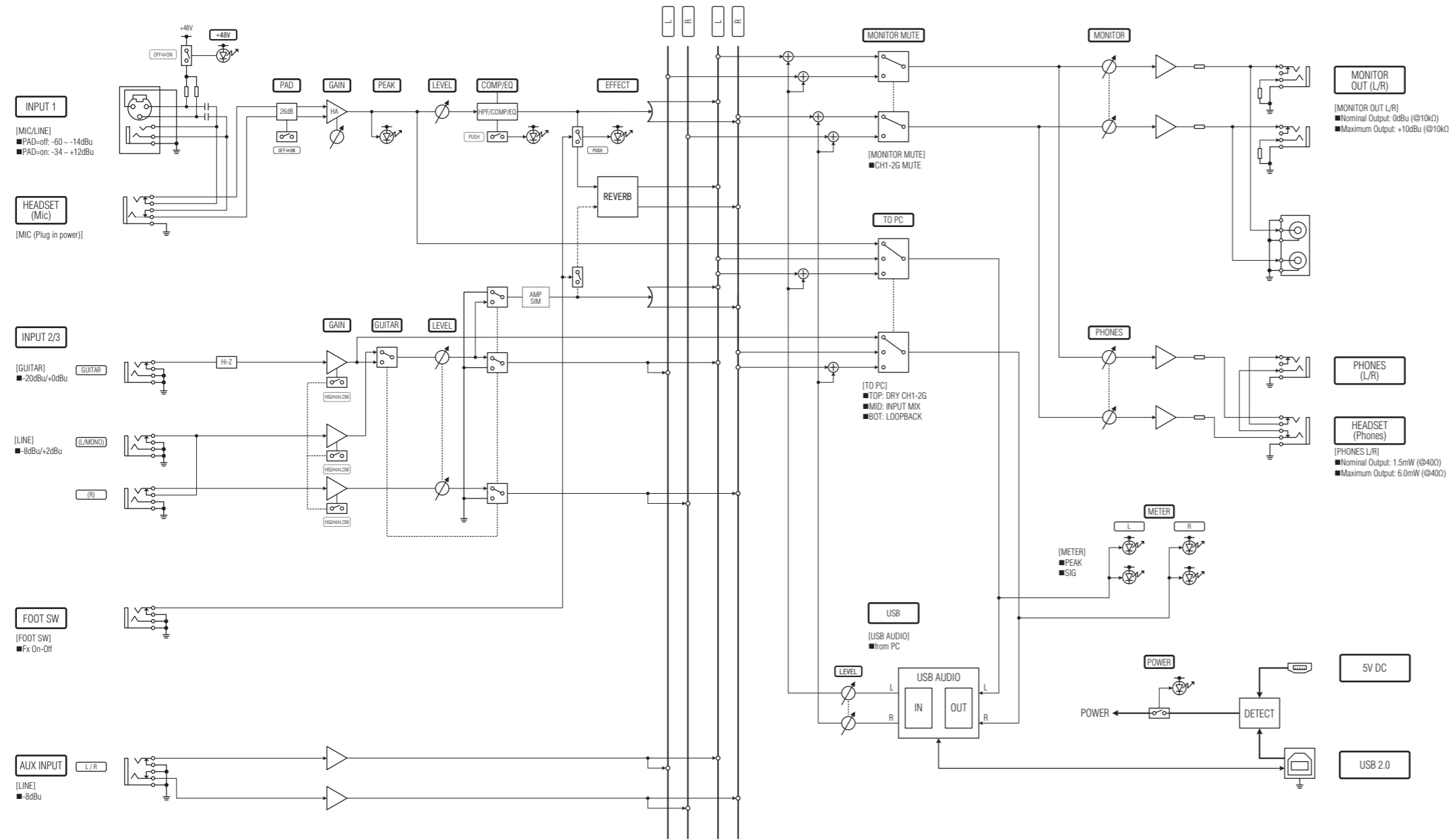

Dimensions

Unit: mm

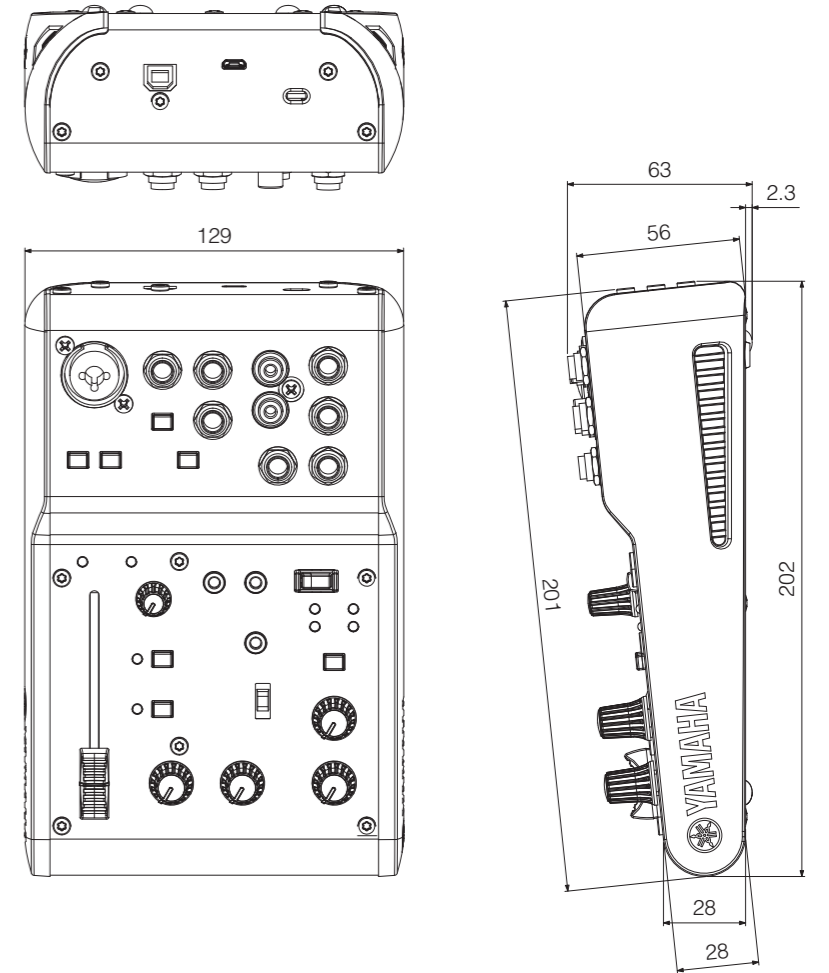

Jack and Plug List

| Jacks and Plugs | Polarities | Balanced/Unbalanced | Configurations |
|---------------------------|--|---------------------|--------------------|
| MIC/LINE | Pin 1: Ground Pin 2: Hot (+) Pin 3: Cold (-) | Balanced | XLR Jack |
| MIC/LINE* MONITOR OUT* | Tip: Hot (+) Ring: Cold (-) Sleeve: Ground | Balanced | TRS Phone Plug |
| HEADSET MIC | Tip: Signal Ring: - Sleeve: Ground | Unbalanced | |
| PHONES AUX | Tip: L Ring: R Sleeve: Ground | - | |
| LINE 2/3 GUITAR | Tip: Signal Sleeve: Ground | Unbalanced | TS Phone Plug |

* These jacks also can be connected with TS phone plugs. If you use TS phone plugs, the connection will be unbalanced.